



Safe-Cell[®] Prison Tapware

PRODUCT CODE:

- 50145



WaterMark
AS/NZS 3718 Lic. WMKA0034
SAI Global



SPECIFICATIONS

- The Safe-Cell[®] Timeflow Push Button Valve is used in prisons, detention centres, high risk institutions, sporting facilities, schools and public area applications
- Time is affected by temperature, flow rate and pressure, and is based on set at 500kPa, 4LPM @ 22°C.
- Once activated, this timed flow product will allow water to flow for approximately 15 seconds*
- Designed for easy bench installation (maximum thickness 10mm)

Note: This is a single temperature product, so if warm water is required this needs to be premixed prior to reaching the valve. This can be done by using a CliniMix[®] Thermostatic Mixing Valve.

IMPORTANT: All Safe-Cell[®] prison taps are tested in accordance with AS/NZS 3718 and leave our premises in good working order.

TECHNICAL DATA

Inlet	1/2" BSP – Male	
Outlet	1/2" BSP – Male	
Headwork	Time flow cartridge	
Working Pressure Range (kPa)	Min	100
	Max	500
Working Temperature Range (°C)	Min	5
	Max	70
Nominal Flow Rate (LPM)	3 to 4.5	
Finish	Chrome	

NOTE: Galvin Specialised continually strive to improve their products. Specifications may change without notice.

PRE-INSTALLATION

MOUNTING DETAILS

- If the mounting holes do not already exist, mark out and drill the holes in the bench/trough, as shown in rough-in dimensions.
- Please note the maximum thickness of the bench/trough is 10mm.

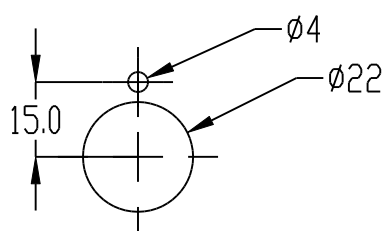

ROUGH-IN DIMENSIONS

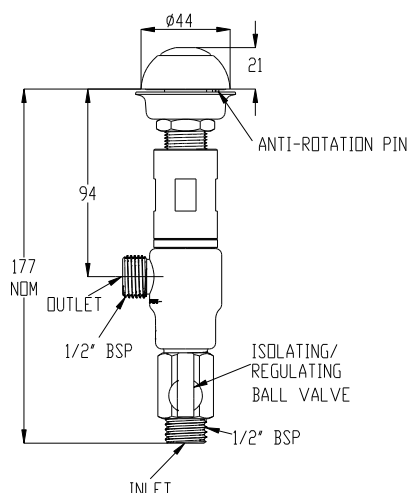

TOOLS REQUIRED

- Power drill
- Spanner or adjustable crescent

INSTALLATION

IMPORTANT: Galvin Specialised products must be installed in accordance with these installation instructions and in accordance with AS/NZS 3500, the PCA and your local regulatory requirements. Water and/or electrical supply conditions must also comply to the applicable national and/or state standards. Failing to comply with these provisions shall void the product warranty and may affect the performance of the product.

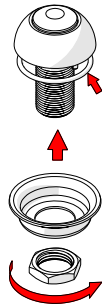

1. Fit push button

- Fit the push button into the bench.
- Ensure the sealing o-ring is placed underneath the push button and the anti-rotation pin locates properly.
- Secure underneath with the supplied cup washer and back nut.

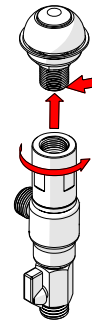

2. Assemble valve body

- Assemble the valve body to the push button.
- Ensure to apply thread tape for sealing. Take care not to over-tighten.

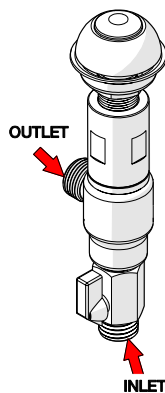

3. Fit inlet and outlet connections

- Fit outlet connection.
- Connect water supply to isolation valve inlet

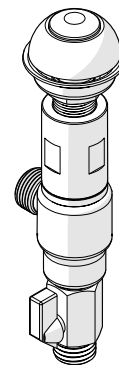

4. Testing

- Turn mains supply on and push button to ensure that there is flow from outlet.
- Inspect the tap and check for any leaks.
- Adjust flow with isolation valve, so required flow is achieved

TROUBLESHOOTING		
PROBLEM	CAUSE	RECTIFICATION
Inconsistent flow	Blocked flow restrictor	Remove isolation valve, remove flow restrictor & clean with water
	Dirt in the top assembly cartridge	Remove cartridge, clean with water and re-grease spindle if required.
Continuous flow	Top assembly cartridge loose, internally obstructed or damaged.	Remove cartridge, clean with water and re-grease spindle if required.
Water is not flowing from tap	Supply not on	Turn water on
	Blocked flow restrictor	Remove flow restrictor from tap and remove debris. Install an inline strainer to stop further blockages.
	Isolation valve is closed	Open isolation valve
Rate of flow inadequate	The flow restrictor may not be satisfactory due to inadequate supply pressure	Remove flow restrictor and replace with a flow restrictor of different capacity to suit (available from Galvin Specialised)
	Isolation valve is positioned wrong	Adjust isolation valve until desired flow is achieved
Button hard to press	The mains pressure may be too great	Reduce to below 500kPa (70PSI), re-grease spindle if required

WARRANTY

The warranty set forth herein is given expressly and is the only warranty given by the Galvin Engineering Pty Ltd. With respect to the product, Galvin Engineering Pty Ltd makes no other warranties, express or implied. Galvin Engineering Pty. Ltd. hereby specifically disclaims all other warranties, express or implied, including but not limited to the implied warranties of merchantability and fitness for a particular purpose.

Galvin Engineering Pty Ltd products are covered under our manufacturer's warranty available for download from www.galvinengineering.com.au Galvin Engineering Pty Ltd expressly warrants that the product is free from operational defects in workmanship and materials for the warranty period as shown on the schedule in the manufacturer's warranty. During the warranty period, Galvin Engineering will replace or repair any defective products manufactured by Galvin Engineering without charge, so long as the terms of the Manufacturer's warranty are complied with.

The remedy described in the first paragraph of this warranty shall constitute the sole and exclusive remedy for breach of warranty, and Galvin Engineering Pty Ltd shall not be responsible for any incidental, special or consequential damages, including without limitation, lost profits or the cost of repairing or replacing other property which is damaged if this product does not work properly, other costs resulting from labour charges, delays, vandalism, negligence, fouling caused by foreign material, damage from adverse water conditions, chemical, electrical or any other circumstances over which Galvin Engineering has no control. This warranty shall be invalidated by any abuse, misuse, misapplication, improper installation or improper maintenance or alteration of the product.

